

HDMI HDBaseT-Lite Transmitter with EU / US Wall Plate / PoH VE1801AEUT / VE1801AUST

The ATEN VE1801AEUT / VE1801AUST HDMI HDBaseT-Lite transmitter delivers 4K signals up to 40 m over a single Cat 5e/6/6a or ATEN 2L-29330 Cat 6a cable, ensuring users to stabilize HDMI signal transmission with support of 3D, Deep color and embedded HD lossless audio formats. During high-quality video transmission, the transmitter can resist signal interference with the equipped HDBaseT Anti-jamming technology and offer a reliable signal extension.

The VE1801AEUT / VE1801AUST can be easily mounted in a 1-gang junction box with EU / US wall plate, concealing bulky cable setups and presenting needed information in sight. In addition, with built-in PoH (Power over HDBaseT) function, the VE1801AEUT / VE1801AUST receives power supply from a connected PoH PSE supported receiver and streamlines complex power line deployment.

Expanding on previous models by the share function, the VE1801AEUT / VE1801AUST can remotely switch source when connecting to a compatible receiver, e.g., VP1421, bringing users for more convenient AV extension. This compact transmitter provides a neat and simple installation on walls or tables, enabling users to elegantly immerse their AV applications into any environment. Therefore, the VE1801AEUT / VE1801AUST is ideal for use in meeting rooms, digital educational environments or any application requiring stable high-quality transmission and effortless installation.



VE1801AEUT Front View



VE1801AEUT Rear View

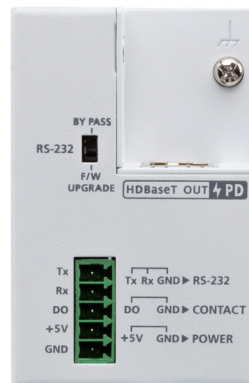

VE1801AEUT Top View



VE1801AUST Front View



VE1801AUST Rear View

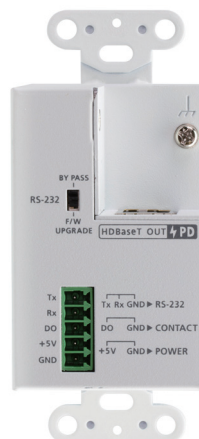

VE1801AUST Top View



Features

- Extends HDMI signals with superior video quality over a single Cat 5e/6/6a cable or ATEN 2L-29330 Cat 6a cable
 - 4K up to 40 m
 - 1080p up to 70 m
- Built-in PoH (Power over HDBaseT) function — the VE1801AEUT / VE1801AUST receives power supply from the HDBaseT output port
- HDMI (3D, Deep color, 4K); HDCP 2.2 compliant
- Designed to mount in a 1-gang junction box with EU / US wall plate
- Supports RS-232 channel transmission
- Consumer Electronics Control (CEC) allows interconnected HDMI devices to communicate and respond to a single remote control
- HDBaseT Anti-jamming — resists signal interference during high-quality video transmission using HDBaseT technology
- Share function — the VE1801AEUT / VE1801AUST can remotely switch source when connecting to a compatible receiver, e.g., VP1421
- LED indication of device status
- Supports wide screen format
- Built-in 8KV / 15KV ESD protection
- Plug-and-play

VE1801AEUT

Front View

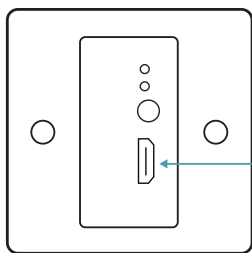

Rear View

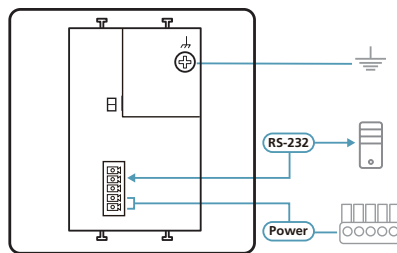

Top View

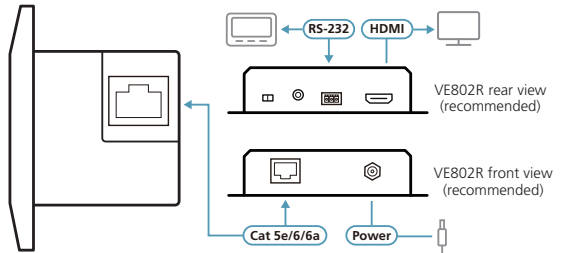

VE1801AUST

Front View

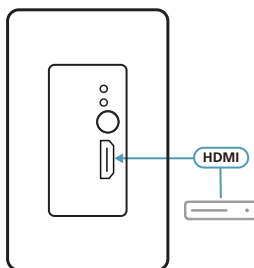

Rear View

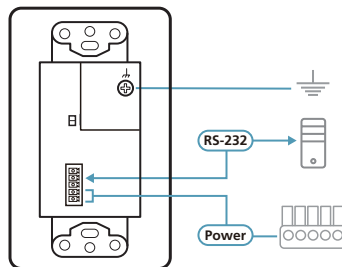

Top View

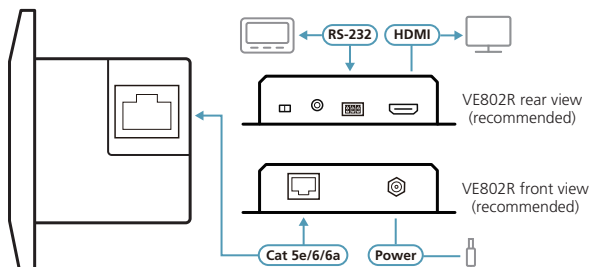

Specifications

	VE1801AEUT	VE1801AUST
Video Input		
Interfaces	1 x HDMI Type A Female (Black)	
Impedance	100 Ω	
Max. Distance	3 m	
Video		
Max. Data Rate	10.2Gbps (3.4Gbps per lane)	
Max. Pixel Clock	340 MHz	
Compliance	HDMI (3D, Deep Color, 4K) HDCP 2.2 Compatible Consumer Electronics Control (CEC)	
Max. Resolutions / Distance	Up to 4K @ 35 m (Cat 5e/6) / 40 m (Cat 6a/ATEN 2L-29330 Cat 6a); 1080p @ 60 m (Cat 5e/6) / 70 m (Cat 6a/ATEN 2L-29330 Cat 6a) *4K supported: 4096 x 2160 / 3840 x 2160 @ 60Hz (4:2:0); 4096 x 2160 / 3840 x 2160 @ 30Hz (4:4:4)	
Audio		
Input	1 x HDMI Type A Female (Black)	
Control		
RS-232 Channel	1 x Terminal Block (3 pole, Tx/Rx/GND, Green)	
Contact Out	1 x Terminal Block (2 pole, DO/GND, Green)	
Connectors		
Unit to Unit	1 x RJ-45 Female	
Power	1 x Terminal Block (2 pole, +5V/GND, Green) or 1 x RJ-45 Female (PoH)	
Power Consumption	DC5V: 3.26W PoH: 4W	DC5V: 3.26W PoH: 4W
Environmental		
Operating Temperature	0 – 40°C	
Storage Temperature	-20 – 60°C	
Humidity	0 – 80% RH, Non-condensing	
Physical Properties		
Housing	Metal	
Weight	0.20 kg	0.21 kg
Dimensions (L x W x H)	6.86 x 4.44 x 5.00 cm	10.41 x 4.44 x 5.00 cm
Faceplate Dimensions (L x W x H)	8.60 x 8.60 x 1.60 cm	11.39 x 6.99 x 0.64 cm

ATEN International Co., Ltd.

3F., No.125, Sec. 2, Datung Rd., Sijhih District., New Taipei City 221, Taiwan
 Phone: 886-2-8692-6789 Fax: 886-2-8692-6767
 www.aten.com E-mail: marketing@aten.com

Product information is subject to change without prior notice.

Released: 01/2025 V2.0

© Copyright 2025 ATEN® International Co. Ltd.
 ATEN and the ATEN logo are registered trademarks of ATEN International Co., Ltd.
 All rights reserved. All other trademarks are the property of their respective owners.
 The terms HDMI, HDMI High-Definition Multimedia Interface, and the HDMI Logo are trademarks or registered trademarks of HDMI Licensing Administrator, Inc.

