

HSA-500 Series

Wi-Fi HotSpot | SD-WAN

Overview

mbox HotSpot Access (HSA-500) is an integrated Machine-To-Machine (M2M) and SD-WAN appliance designed for retail or small networks, with all essential enterprise features, incorporating advanced networking & security technologies, TCP/IP routing, Multi-WAN bonding, firewall/VPN, bandwidth control, and dual-band Wi-Fi, all packed into a powerful appliance.

mbox's "zero-config" feature enables speedy onsite deployment without the need of any certified network engineer, while its cloud management capabilities enables Managed Service Provider (MSP) to massively manage and monitor all deployed mboxes at fingertips.

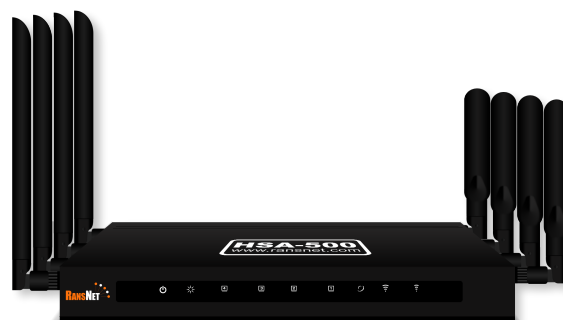
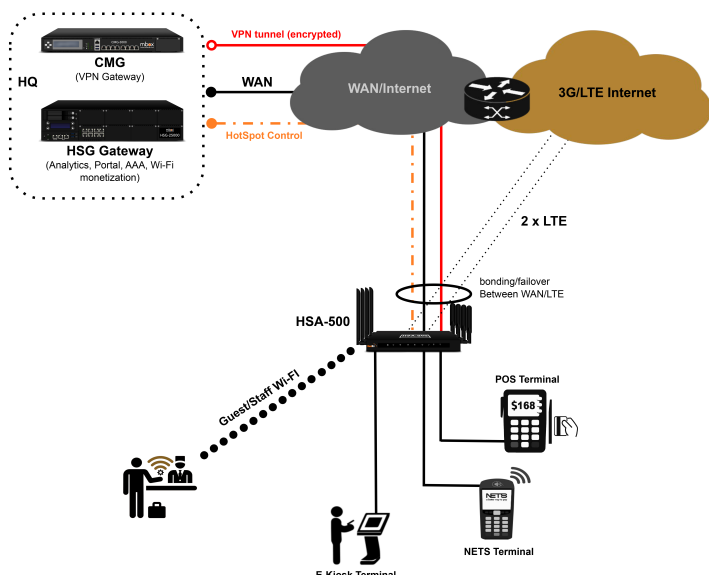

What HSA does?

- Links to any WAN (Internet/MPLS/LL/Ethernet/LTE)
- Connects to local devices through wired or wireless
- Balances multiple ISP links with auto failover
- Multi-homes critical networks with BGP and VRRP
- Prioritizes critical applications or VIP users
- Encrypts business transactions using secure VPN
- Monetises Wi-Fi infra through advertising engines
- Analyses network/user behaviour for business visibility

What's so special about HSA?

- Integrated M2M & SD-WAN appliance
- Wi-Fi monetization appliance for maximum returns
- Cloud management with zero-config deployment

Who need HSA?

- Banks, to connect remote ATMs back to HQ securely and reliably
- Service Providers, to deploy SD-WAN solution and manage massive remote CPEs at ease
- Retail F&B outlets, to secure transactions to HQ/DC
- Transport providers, to offer "Wi-Fi on the go"

Specifications

	HSA-500W	HSA-500L1	HSA-500L2
Performance			
Processor	Multi-core	Multi-core	Multi-core
Memory (RAM)	512M	512M	512M
Router throughput	500Mbps	500Mbps	500Mbps
Multi-WAN (WAN bonding)	Up to 4 WAN	Up to 5 WAN	Up to 6 WAN
GE Interface	5	5	5
IEEE802.11 a/b/g/n/ac Wi-Fi	✓	✓	✓
SSID Supported	16	16	16
4G/LTE Supported (with Quectel EC25-E module)	-	Single SIM	Dual SIM (Active : Active)
Network and Security			
Stateful Firewall, NAT, SNAT, DNAT	✓	✓	✓
DHCP services (client and server)	✓	✓	✓
VLAN/Trunking support (802.1q)	✓	✓	✓
IPSec, L2TPv3, GRE, SSLVPN	✓	✓	✓
High availability (VRRP)	-	-	-
Static routing, Policy-Based Routing	✓	✓	✓
Dynamic routing (RIP, OSPF, BGP)	✓	✓	✓
IPv4 and IPv6 capable	✓	✓	✓
Proxy, URL/DNS filtering	✓	✓	✓
Bandwidth control (QoS)	✓	✓	✓
External HotSpot portal support	✓	✓	✓
Wi-Fi Monetization	✓	✓	✓
Cloud Management and Monitoring			
mfusion monitoring & management	✓	✓	✓
Throughput testing and user experience monitoring	✓	✓	✓
Online firmware patching/updates	✓	✓	✓
Physical & Environmental Specifications			
Dimensions (WxHxD)	226 x 140 x 35	226 x 140 x 35	226 x 140 x 35
Weight	0.8kg	0.8kg	0.8kg
Design form factor	Small form factor	Small form factor	Small form factor
Power Consumption	<15W	<15W	<15W
Operating temperature	-10°C to 60°C	-10°C to 60°C	-10°C to 60°C