

12-Port Gigabit IEEE 802.3at PoE+ Managed Injector Hub (220 watts)



High Power PoE for Public Service PoE Applications

PLANET POE-1200G, a 12-port Gigabit IEEE 802.3at PoE Web Management Injector Hub, features multi-port Gigabit IEEE 802.3at PoE+ Web management, both IEEE 802.3af and IEEE 802.3at Power over Ethernet Plus (PoE+) that combine up to 30-watt power output and data per port over one Cat5e/6 Ethernet cable. It is designed specifically to satisfy the growing demand for higher power consuming network PDs (powered devices), such as PTZ (Pan, Tilt and Zoom), speed dome network cameras, multi-channel (802.11a/b/g/n) wireless LAN access points and other network devices by providing the double amount of PoE power, more than the conventional 802.3af PoE PSE.

Complying with IEEE 802.3at PoE Standard

Though the IEEE 802.3af Power over Ethernet Standard is still popular today, the IEEE 802.3at Power over Ethernet Plus standard is gradually taking over as the PoE demand for network-powered applications is on the increase. With many critical applications on the increase, the demand for higher power increases. Hence, the IEEE 802.3at PoE Plus is able to deliver a maximum of 30 watts of input power to each PoE device. Compliant with IEEE 802.3at, the POE-1200G Injector Hub possesses stronger power capability than the existing 802.3af PoE PSE and is an ideal solution to meeting the high power requirements directly via the RJ45 interface.

PTZ / Speed Dome Camera

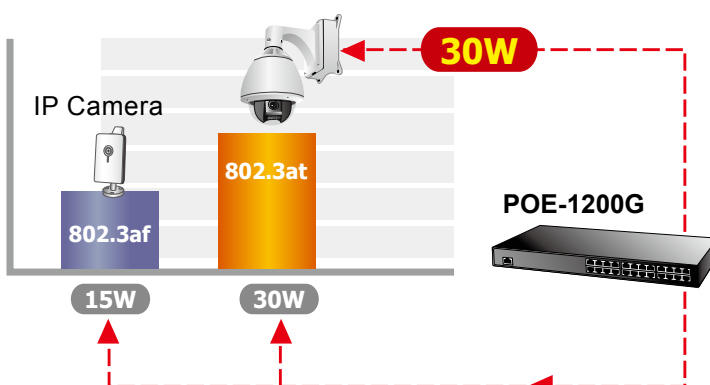

Interface

- Complies with the IEEE 802.3, IEEE 802.3u and IEEE 802.3ab Ethernet standards
- **24-port RJ45**
 - 12-port 10/100/1000Mbps **“Data input”**
 - 12-port 10/100/1000Mbps **“Data + Power output”**
- One 10/100/1000BASE-T management port
- Reset button for system management

Power over Ethernet

- Complies with IEEE 802.3at and IEEE 802.3af Power over Ethernet mid-span PSE
- Up to 12 IEEE 802.3at/802.3af devices powered
- 220-watt PoE budget
- Supports PoE power up to 30.8 watts (802.3at PoE)/15.4 watts (802.3af PoE) for each PoE port
- Automatically detects powered device (PD)
- Circuit protection prevents power interference between ports
- Remote power feeding up to 100m cable length

PoE Management

- Per port PoE power schedule
- PoE function enable/disable
- Per port PoE function enable/disable
- PoE port power feeding priority
- PD classification detection
- Over temperature protection
- PD alive-check

Management

- Web interface for remote management
- Supports Network Time Protocol (NTP)
- Firmware upgrade through Web interface
- PLANET Smart Discovery utility automatically finds PLANET devices on the network
- SNMP trap for alarm notification of events
- System log and remote syslog

Hardware

- 19-inch rack mountable; 1U height
- Reset button for resetting to default setting and system reboot
- LED indicators for PoE ready and PoE activity
- LED indicators for power alert and fan alert
- FCC Part 15 Class A, CE

Intelligent Powered Device Alive Check

The POE-1200G can be configured to monitor connected PD (Powered Device) status in real time via ping action. Once the PD stops working and is without response, the POE-1200G will resume the PoE port power and bring the PD back to work. It will greatly enhance the network reliability through the PoE port resetting the PD's power source and reduce administrator management burden.

PoE PD Alive-checking

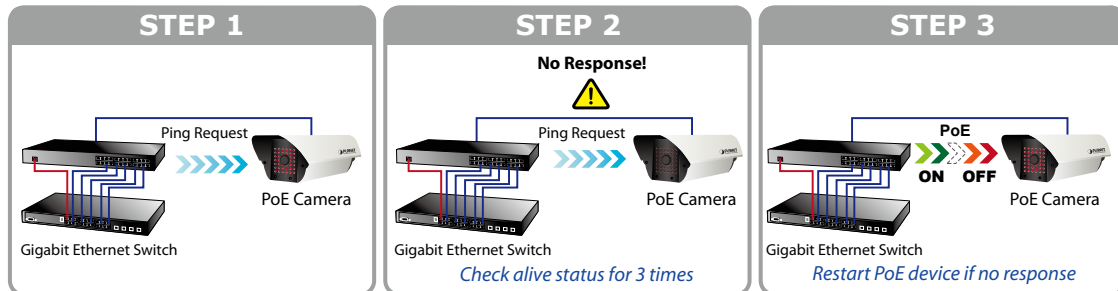

PoE Schedule for Energy Saving

Under the trend of energy saving worldwide and contributing to environment protection on the Earth, the POE-1200G can effectively control the power supply besides its capability of giving high watts power. The "PoE Schedule" function provided by the POE-1200G helps you to enable or disable PoE power feeding for each PoE port during specified time intervals and it is a powerful function to help SMBs or enterprises save power and money.

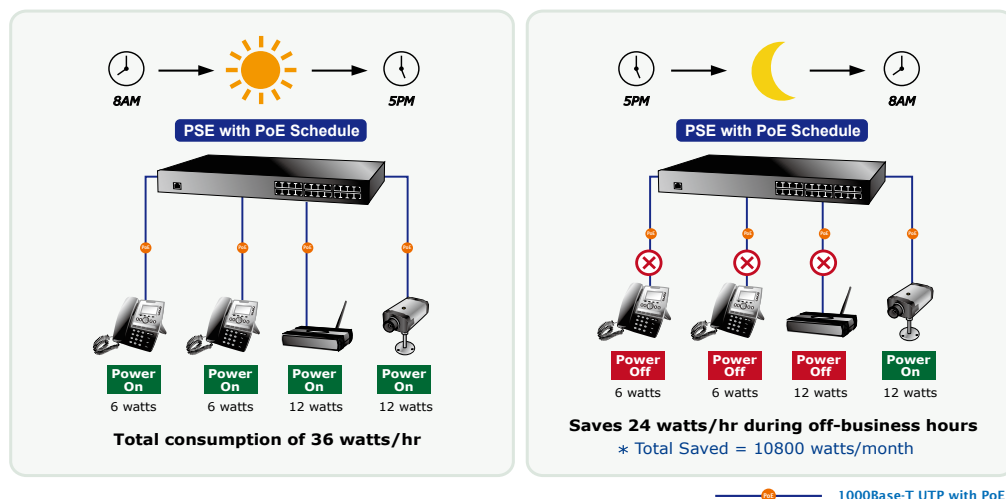

Advanced Power Management

To facilitate power management, the POE-1200G comes with powerful PoE management features, such as over temperature protection, usage threshold alert and auto power allocation, to prevent power budget overloading. The PoE power budget can be allocated by priorities or classification and can send event logs when power usage reaches the defined threshold. The POE-1200G enables centralization of the power supply and optimizes the installation and power management of remote network devices; therefore, it eliminates costs for additional AC wiring and reduces installation time.

Quick and Easy PoE Network Deployment

The POE-1200G complies with IEEE 802.3, IEEE 802.3u, IEEE 802.3ab, IEEE 802.3af and IEEE 802.3at standards. With 12 **10/100/1000BASE-T Gigabit** Ethernet ports, the POE-1200G supports 52V DC power for any remote 802.3af/802.3at powered device (PD). Supporting PoE power budget of **220 watts**, the POE-1200G provides sufficient 30.8-watt (max.) PoE power to up to 12 remote 802.3at/802.3af PD devices.

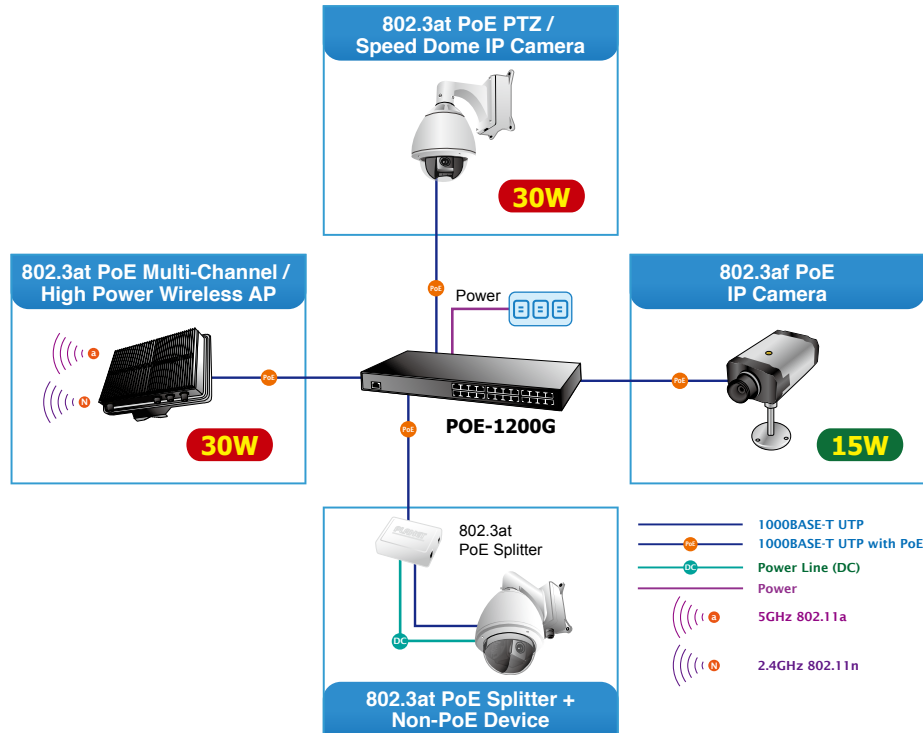

Easy Cabling Installation

The POE-1200G is installed between a regular Ethernet Switch and the powered devices. It injects power to the PDs without affecting **data** transmission performance. It offers a cost-effective and quick solution to upgrading network system to IEEE 802.3af/IEEE 802.3at Power over Ethernet system without replacing the existing Ethernet Switch. There are 24 RJ45 STP ports on the front panel of the POE-1200G, of which the 12 ports on the lower stack function as "**Data input**" and the other 12 ports on the upper stack function as "**PoE (Data and Power) output**". The 12 "**PoE output**" ports are also the power injectors that transmit DC voltage to the Cat5/5e/6 cable and transfer data and power simultaneously between the Ethernet Switch and the powered devices.

Friendly Web Management Interface

To efficiently manage the powered devices, the POE-1200G provides simple Web management interface in which administrators can control the functions including port enable/disable, port priority, system configuration, change in user name and password, and smart features for powered devices. The PoE injector hub can automatically detect the power status of each port and show messages on its Web management interface. These features also provide users with a cost-effective way to manage the device via Internet whenever they are at work or at home.

Applications

Gigabit PoE Network Deployment

The POE-1200G provides the easiest way to power your Ethernet devices such as IP camera on the ceiling and the wireless access point installed on the top of the building. With 12 10/100/1000BASE-T Gigabit Ethernet ports, the POE-1200G supports full 52V DC power for any remote IEEE 802.3af/IEEE 802.3at powered device (PD).

To control the power system of your networking devices, the POE-1200G can directly co-work with network devices such as PoE IP phone to build VoIP telephony network in the office. Furthermore, the PoE hub can be directly connected to any third-party IEEE 802.3af/802.3at compliant devices installed within 100 meters.



Specifications

Model		POE-1200G
Hardware		
Hardware Version		3
Interface	“Data” Input Ports	12 x RJ45
	“Data+Power” Output Ports	12 x RJ45
	Management Port	1 x RJ45; 10/100/1000BASE-T, auto-negotiation, auto-MDI/MDIX
Data Rate		10/100/1000Mbps
LED		System: SYS PWR x 1 (green) PoE Failure x 1 (red) Fan Failure x 1 (red) Per PoE Port: PoE-in-use x 1 (green) Management port: 1000 (green), 10/100 (orange)
Network Cable		10BASE-T: 4-pair UTP Cat5 up to 100m (328ft) 100BASE-TX: 4-pair UTP Cat5 up to 100m (328ft) 1000BASE-T: 4-pair UTP Cat5e/6 up to 100m (328ft) EIA/TIA- 568 100-ohm STP (100m)
Power Requirements		100-240V AC, 50/60 Hz, 4A
Power Consumption		250 watts (max.)
Ventilation		Fan x 2
Power over Ethernet		
PoE Power Supply Type		Mid-span
PoE Power Output		Per port DC 52V 30.8/15.4 watts
Power Pin Assignment		4/5(-), 7/8(+)
PoE Power Budget		220 watts
Number of 802.3af PD Class 0, 1, 2, 3 can be powered		12
Number of 802.3at PD Class 1, 2, 3 can be powered		12
Number of 802.3at PD Class 0, 4 can be powered		7
Management		
Management Interface		Web, PLANET Smart Discovery Lite
PoE Management		Power limit by consumption and classification PoE admin mode Per port power schedule Per port power enable/disable Power feeding priority Over temperature protection Current per port usage and status Total power consumption
Management Feature		Setup of system/management functions Web firmware upgrade SNMP trap for alarm notification of events
Standards Conformance		
Standards Compliance		IEEE 802.3 10BASE-T Ethernet IEEE 802.3u 100BASE-TX Fast Ethernet IEEE 802.3ab 1000BASE-T Gigabit Ethernet IEEE 802.3at High Power over Ethernet IEEE 802.3af Power over Ethernet RFC 768: UDP RFC 791: IP RFC 2068 HTTP RFC 1157: SNMP v1 RFC 1902: SNMP v2c RFC 5424: Syslog

Ordering Information

POE-1200G	12-Port Gigabit IEEE 802.3at PoE+ Managed Injector Hub (220 watts)
-----------	--

Related Products

ICA-2250VT	Industrial PoE Plus Outdoor IR IP Camera
ICA-2500	5 Mega-pixel PoE Box IP Camera
ICA-3250V	Full HD Outdoor IR PoE IP Camera
ICA-3350P	3 Mega-pixel Remote Focus Bullet IR IP Camera
ICA-E3550V	5 Mega-pixel Bullet IR PoE IP Camera with Extended Support
ICA-4200V	Full HD 20M IR Vari-focal Dome IP Camera
ICA-4500V	5 Mega-pixel 20M IR Vari-focal Dome IP Camera
ICA-5250	Full HD Ultra-mini Vandal Dome
ICA-HM351	2 Mega-pixel 35M IR Outdoor Box PoE IP Camera
ICA-HM620	2 Mega-pixel PoE Plus Speed Dome Internet Camera
POE-152S	IEEE 802.3af Power over Ethernet Splitter
POE-162S	IEEE 802.3at Gigabit High Power over Ethernet Splitter
POE-E101	IEEE 802.3af Power over Ethernet Extender
POE-E201	IEEE 802.3at Power over Ethernet Extender
WNAP-C3220	802.11n Wireless Ceiling-mount PoE Access Point
WNAP-W2200	802.11n 300Mbps In-Wall Access Point w/USB Charger (EU Type)
WDAP-1750AC	1750Mbps 802.11ac Dual Band Wall-mount Enterprise Wireless Access Point
WDAP-C7200AC	1200Mbps 802.11ac Dual Band Ceiling-mount Wireless Access Point
WDAP-W7200AC	1200Mbps 802.11ac Dual Band Wall-mount Wireless Access Point
WDAP-C7400	900Mbps Dual Band Ceiling-mount Wireless Access Point
ICF-1800	HD Touch Screen Android Multimedia Conferencing Phone
VIP-1010PT	High Definition PoE IP Phone (1-Line)
VIP-2020PT	Enterprise HD PoE IP Phone (2-Line)
VIP-5060PT	Professional HD PoE IP Phone (6-Line)

PLANET Technology Corporation

11F., No.96, Minquan Rd., Xindian Dist., New Taipei City

231, Taiwan (R.O.C.)

Tel: 886-2-2219-9518

Email: sales@planet.com.tw

Fax: 886-2-2219-9528

www.planet.com.tw



PLANET reserves the right to change specifications without prior notice. All brand names and trademarks are property of their respective owners. Copyright © 2015 PLANET Technology Corp. All rights reserved.

POE-1200Gv3